

尺寸及量程 / Size and Capacity

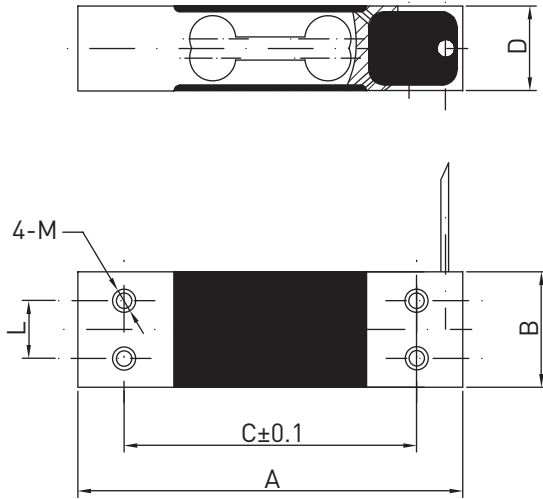

CAP (kg)	SIZE (mm)					
	A	B	C	D	L	M
Option1: 3, 4, 5, 6, 8, 10, 15, 20, 25, 30, 40, 45, 50	130	30	106	22	15	M6
Option2: 3, 4, 5, 6, 8, 10, 15, 20, 25, 30, 40, 45	100	30	76	22	15	M6
Option1: 60, 80, 100	130	40	106	22	15	M6
Option2: 60, 100, 150, 200, 250	130	50	106	22	25	M8

量程 / Capacity: 3~250kg

技术参数 / Technical Parameters

参数	Specifications	技术指标 / Technique
输出灵敏度	Rated Output	2.0 ± 10% mV / V
零点输出	Zero Balance	± 2 % F.S.
非线性	Non-Linearity	0.02 % F.S.
滞后	Hysteresis	0.02 % F.S.
重复性	Repeatability	0.02 % F.S.
蠕变 (30 分钟)	Creep (30min)	0.03 % F.S.
温度灵敏度漂移	Temp. Effect On Output	0.02% F.S. / 10°C
零点温度漂移	Temp Effect On Zero	0.02% F.S. / 10°C
输入电阻	Input Impedance	410 ± 10Ω
输出电阻	Output impedance	350 ± 3 Ω
绝缘电阻	Insulation	≥5000MΩ/100VDC
使用电压	Recommended Excitation	10 V
最大使用电压	Maximum excitation	15 V
温度补偿范围	Compensated Temp. Range	- 10 ~ 40 °C
工作温度范围	Operation Temp Range	- 20 ~ 60 °C
安全超载	Safe Overload	150 % F.S.
极限超载	Ultimate overload)	200 % F.S.
电缆线尺寸	Cable Size	Ø4 × 450mm (Option1) Ø3 × 450mm (Option2)
台面尺寸	Platform Size	250 × 300mm
防护等级	Prot ection Class	IP65
连接方式	Cable color code	Input: Red (+) Black(-); Output: Green(+), White(-); 输入: 红 (+) 黑 (-); 输出: 绿 (+) 白 (-)

特点和用途 / Features & Applications

- 单点平行梁结构，铝合金制称重传感器。
- 精度高、抗偏载能力强，结构简单，容易安装。
- 适用于电子秤、计数秤、电子天平及工业称重系统。
- Single point parallel beam load cell, made of aluminum alloy.
- High Accuracy, high side load tolerance, simple structure, easy to install.
- Mainly used for electronic scales, electronic balance, price computing scales and industrial weighing systems.

受力方式 / Load Direction

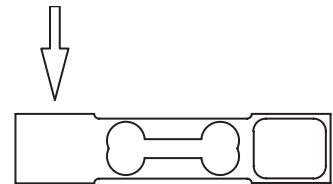

接线图 / Schematic Wiring Diagram

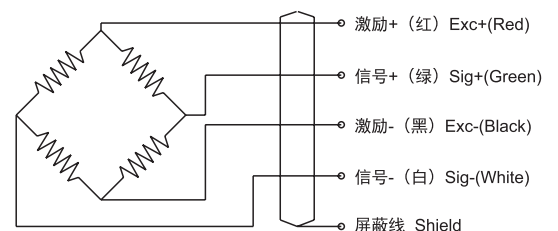

Rev. 02/2014